

## Who we are

East West Corporation Limited, is a privately owned business entity in Hong Kong, with offices in China and South America. With the core business being sourcing, design and development of consumer products, our business model is based on providing a complete set of services, which include and are not limited to distribution, shipping, financing.

We are embarking on a strong base in some countries in South America and aim to deliver a high standard of service to our clients in these regions.

Established since 1968, EWCL employs a small group of staff in their Hong Kong office with customer representatives in different countries.

A trading company, exporter, importer – some of the various names related to the trading business with China being at its core, we consider EWCL as an “integrated service provider” for consumer goods trade – with more product ranges being constantly added to expand our business and markets.



**During Covid19 pandemic world over , the sales of prefab houses has increased tremendously providing safety , comfort , security at affordable prices .**

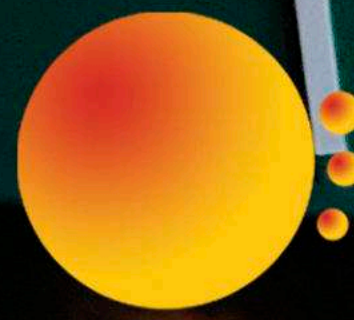

# East West

China Sourcing Solutions

Doing business with the world since 1968



TAQUERIA  
LOS COCUYOS  
TACOS DE:  
SUPIA \$11.00  
CAMPESEÑO \$16.00  
CABEZA \$16.00  
MADRE \$16.00  
CACHETE \$16.00  
OJO  
TRONCO DE ORO  
MOLLEJA  
TROMPA  
TRIPA  
LONGANIZA  
SUAREZ  
LEÑON



GRACIAS  
POR SU  
PROPINA  
THANKS FOR  
YOUR TIP



555142

27Boxes  
Radio Studio



Chickas Smootheries  
SANT CAFE

3628

51

# ENTERPRISE HONOR



## CONSTRUCTION DRAWING DESIGN

We can make the design according to clients' requirements. For the design, it includes floor plan, front and rear elevation, roof plan, profile for steel structure, etc. Our engineers can also analyze the steel structure according to clients' needs of bearing load and local wind speed, and then optimize the drawing to save the cost for clients.

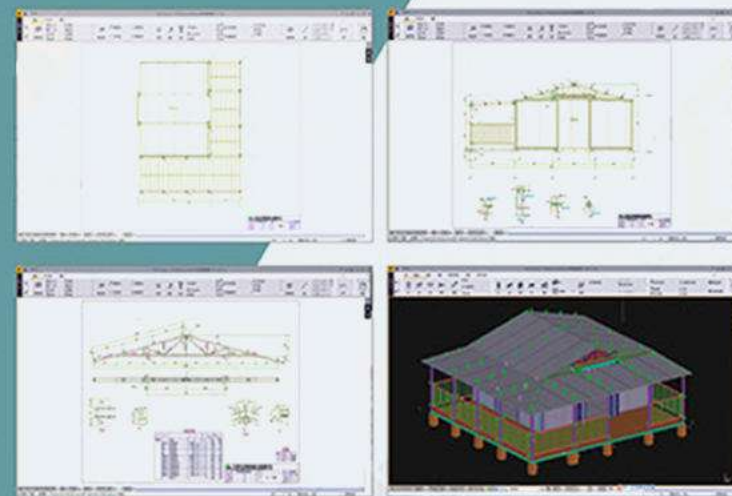

### 3D DESIGN



## 16 PRODUCTION LINES

Annual Production Capacity Of 10.92 Million Square Meters



3.24 million m<sup>2</sup> for prefab houses  
290 containers per day and  
8700 containers per month  
720 portable toilets per month

### ANNUAL OUTPUT



## CONTENTS

- 1 ABOUT US
  - Production Lines
  - Corporate Culture
  - Enterprise Honor
  - Construction Drawing Design
- 2 CONTAINER HOUSE
  - Flat Pack Container
  - Detachable Container House
  - Expandable Container House
  - Foldable Container
  - Maritime Modification Box
  - DIY Shipping Container
- 3 PREFABRICATED HOUSE
  - Prefabricated K House
  - Prefabricated T House
  - Mobile Toilet
- 4
  - Light Steel Villa
  - Steel Series
  - Post Series
  - Movable Wall Series



Doing business with the world since 1968

## ONE-STOP SERVICE



EWCL can offer you one-stop service. We can design according to clients' requirements. We have strict quality control during production, and we can help clients to arrange shipping to their local port or door-to-door.

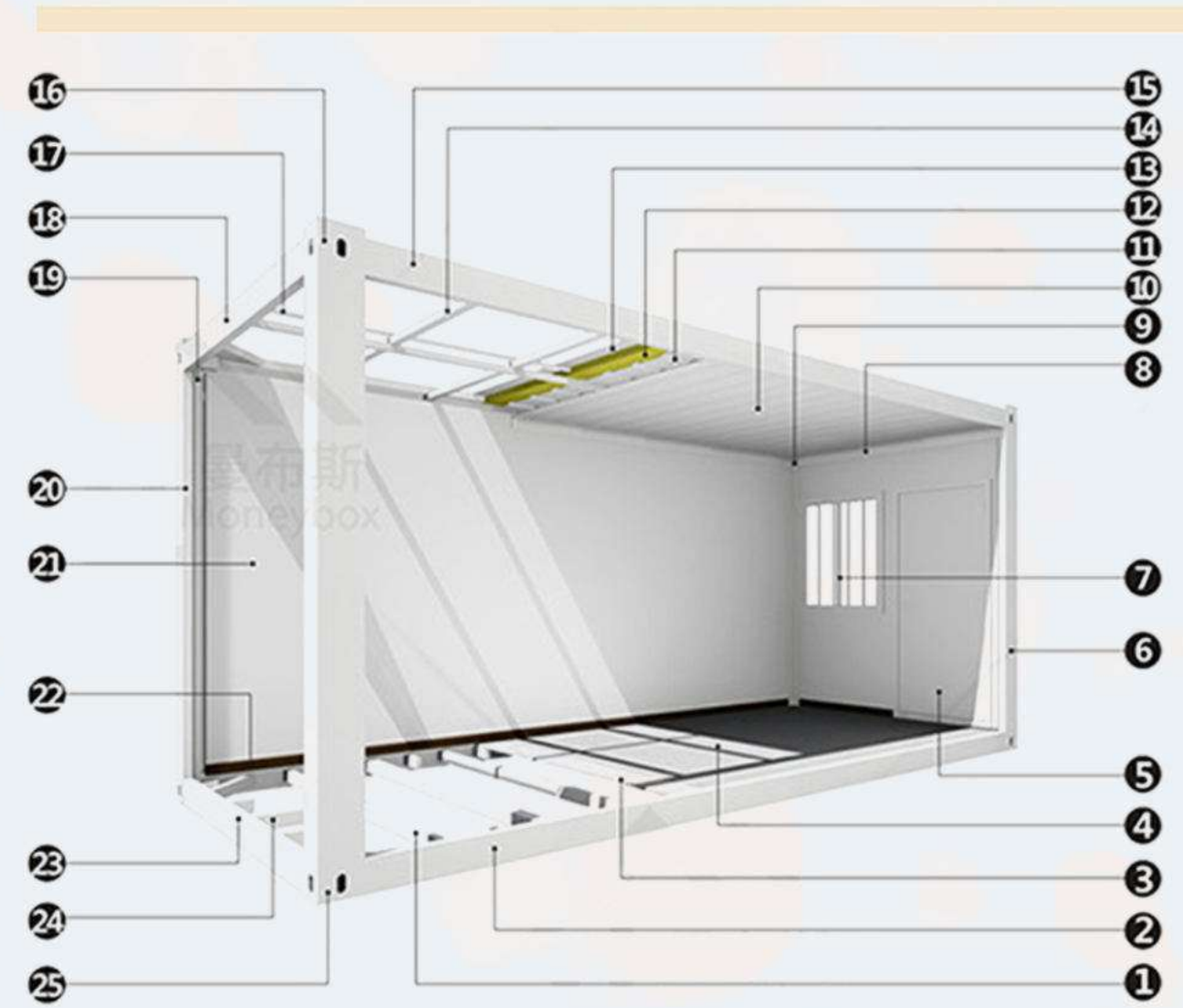

## BIG SMART, EASY LOGISTIC AND HI

- |  |   |
|--|---|
| 1 Bottom Cross Beam, 80x80x1.8mm, 80x40x1.8mm galvanized Steel       | 14 Top Cross Beam, 80x40x1.5mm galvanized Steel                 |
| 2 Bottom Beam, 160x3mm galvanized Steel                              | 15 Top Beam, 160x3.0mm galvanized Steel                         |
| 3 18mm fiber cement board  | 16 Top Corner Fitting, 200x160x210x4mm                          |
| 4 1.6mm PVC Floor leather  | 17 Top Cross Beam, 80x40x1.5mm galvanized Steel                 |
| 5 Steel Door, 840x2040mm   | 18 Top Beam, 160x2.5mm galvanized Steel                         |
| 6 Corner Fitting, 160x210x160x4mm                                    | 19 50mm PVC Downspouts  |
| 7 UPVC Window, double glass 5+9A+5, 800x1100mm with mosquito netting | 20 Angle Steel Pillar, 210x160x2.75mm galvanized Steel          |
| 8 Inside Trim, 0.426mm Steel sheet                                   | 21 50mm EPS sandwich panel, 0.376mm Steel sheet                 |
| 9 Inside Trim, 0.426mm Steel sheet                                   | 22 PVC skirting   |
| 10 0.476mm Steel sheet Ceiling                                       | 23 Bottom Beam, 160x3.5mm galvanized Steel                      |
| 11 Middle Strong Steel Plate, 0.326mm Steel sheet                    | 24 Bottom Cross Beam, 80x80x1.8mm, 80x40x1.8mm galvanized Steel |
| 12 100mm Glass wool 16kg/m <sup>3</sup>                              | 25 Bottom Corner Fitting, 160x210x160x4mm                       |
| 13 Galvanized Steel Plate, 0.476 Steel sheet                         |   |

## GH PREFABRICATED

| Item                 | Standard                          | Customize                              |
|----------------------|-----------------------------------|--|
| Size                 | 5800*2400*2896mm                  |  |
| Steel Structure      | 110g/m <sup>2</sup> +Power Coated | 180g/m <sup>2</sup> +Power Coated      |
| Wall                 | 50mm Sandwich                     | 75mm And 100mm Sandwich Panel          |
| Floor                | 18mm Fiber Coated Board           | 18mm, 20mm And 22mm Fiber Cement Board |
| Roof                 | 100mm Glass Wool                  | 100mm Rock Wool                        |
| Windows              | 800*1100mm                        | As Yours                               |
| Door                 | 840*2040mm                        | As Yours                               |
| Wind Resistant       | 0.3kn/m <sup>2</sup>              | 0.3kn/m <sup>2</sup>                   |
| Earthquake Resistant | 8 Grade                           | 8 Grade                                |
| Floor Load Capacity  | 3kn/m <sup>2</sup>                | 3kn/m <sup>2</sup>                     |
| Loading              | 8 Sets/40 Hq                      | /                                      |
| Time To Install      | 2 Sets/4 workers                  | 2 Sets/4 workers                       |



- ✓ 100% Water Proof
- ✓ Wind Resistant
- ✓ Earth Resistant
- ✓ Rust And Corrosion Resistant
- ✓ Popular In Europe
- ✓ Easy Step
- ✓ Durable And Comfortable

## PACKING AND SHIPPING

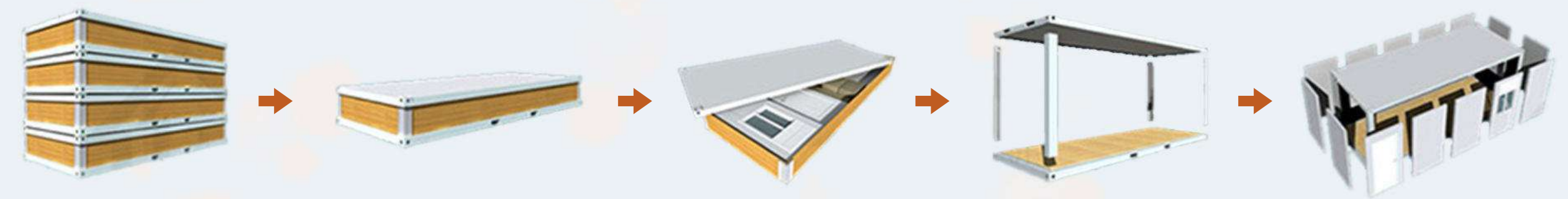

## MORE DETAILS



800x1100mm plastic steel window



840x2040mm steel door

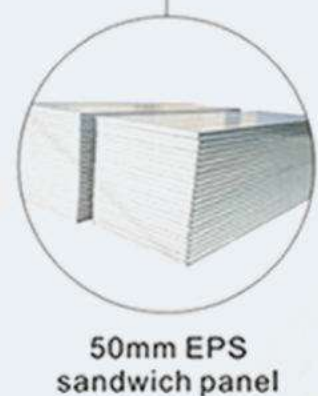

50mm EPS sandwich panel



- top corner fitting
- industrial socket
- exterior top steel plate
- column

The wire

The falling water system

- bottom corner fitting
- 18mm fiber cement board
- PVC floor

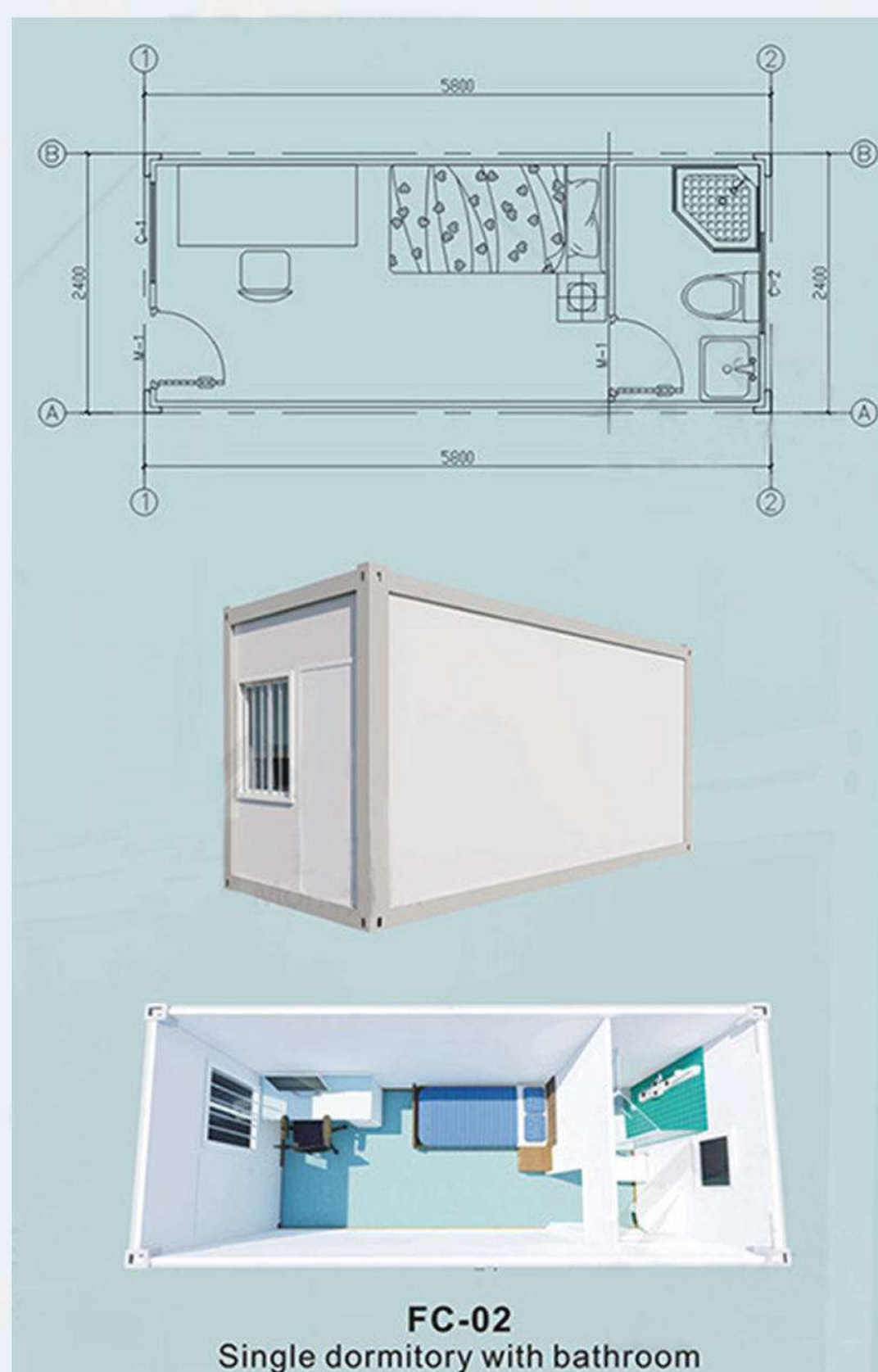
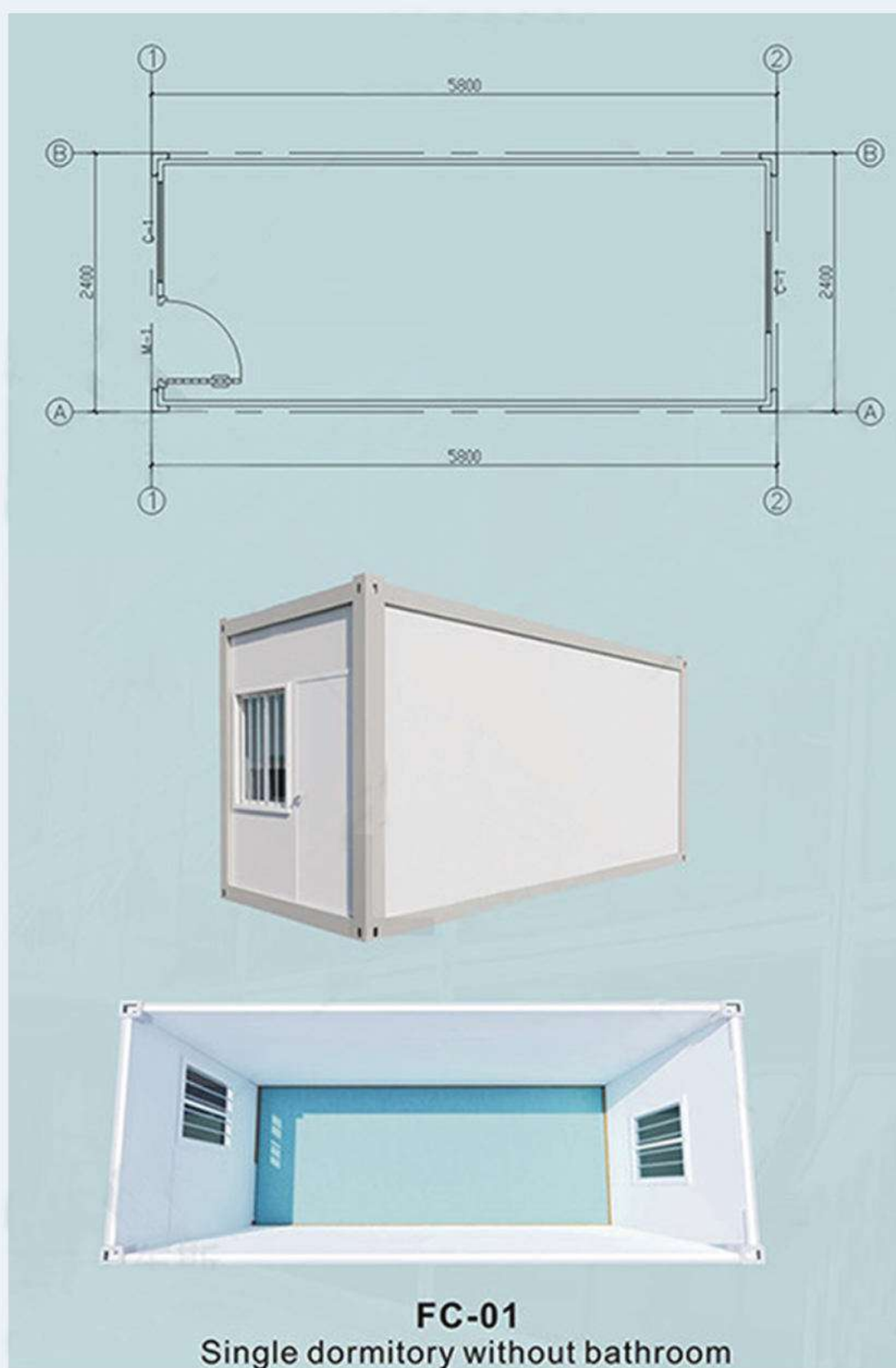
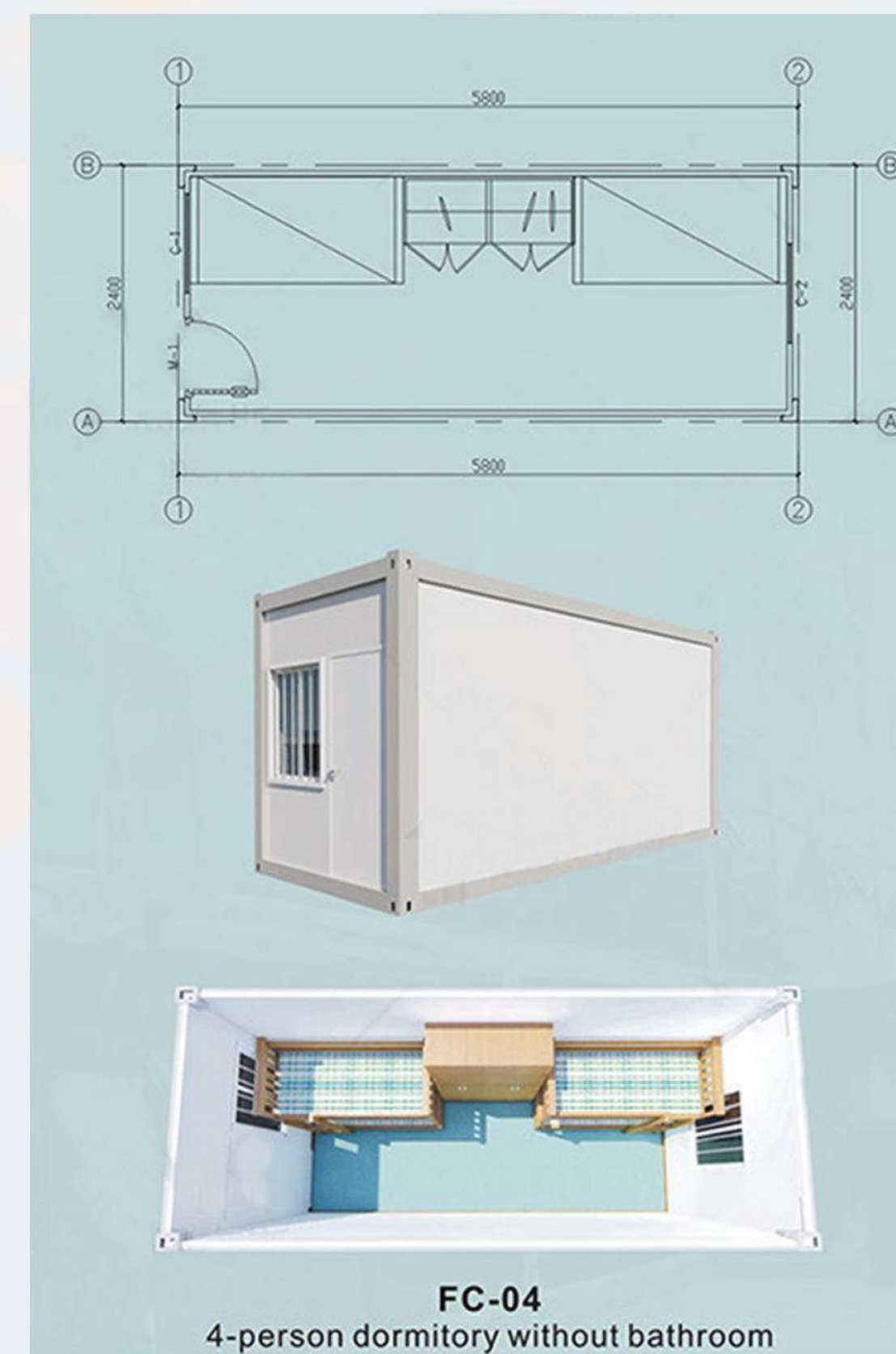
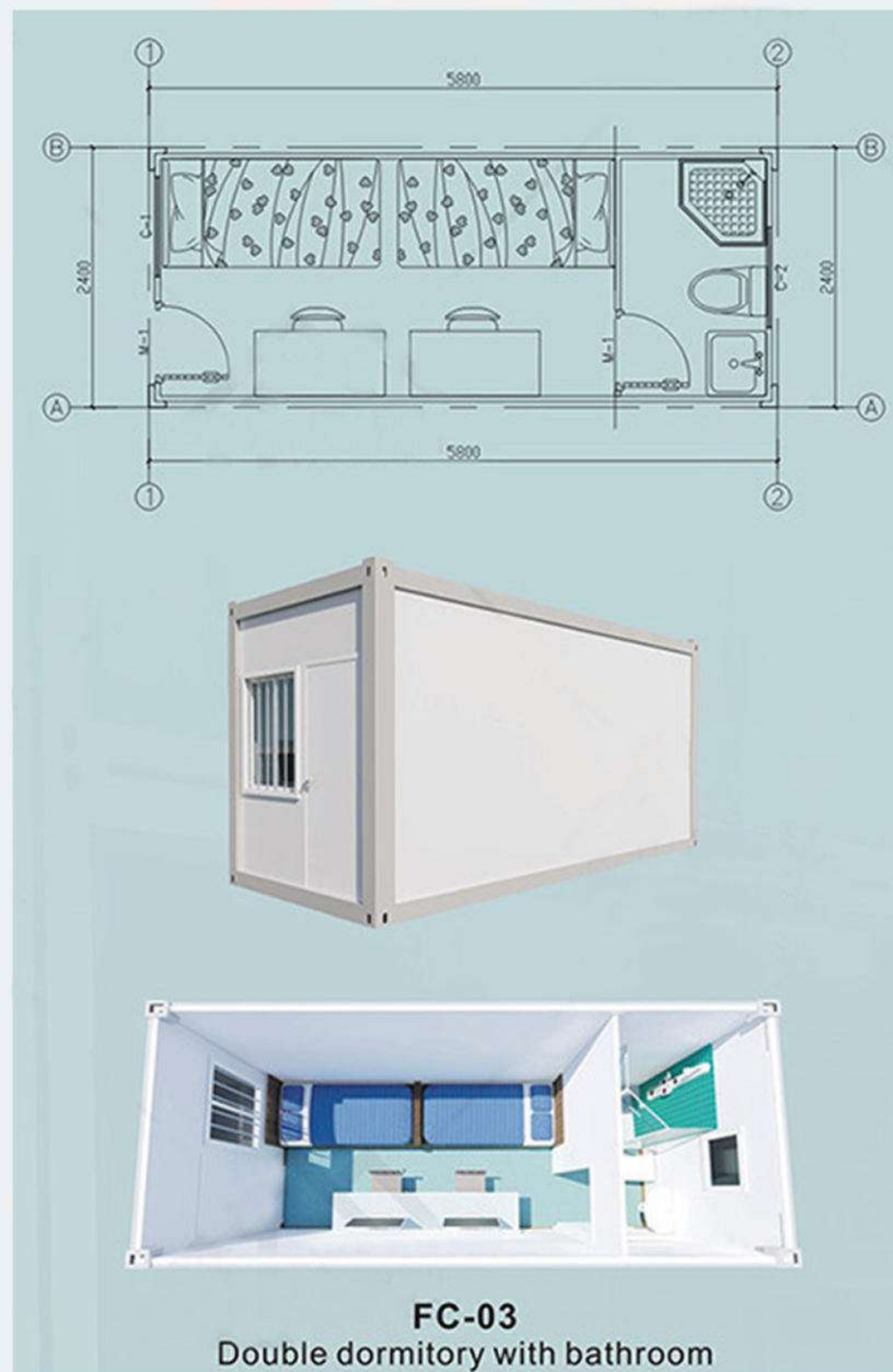

**EASY TO INSTALL**

**1. Install frame**   **2. install wall panels**   **3. install windows and door**

**4. install floor**   **5. Install electricity**   **6. Finish**

**Maintenance**

- Beam bending part
- Square tube
- Eps Sandwich Panel
- Rock wool Sandwich Panel
- Inside Trim
- Compartment floor

**Types of electrical optional**

- Ceiling lights
- Plugs
- Exhaust fan
- Distribution Box

**Doors and windows**

- PVC skirting
- PVC Downspouts
- Industrial plugs
- Aluminum Window
- PVC sliding window
- PVC shutter
- Steel door



*Doing business with the world since 1968*





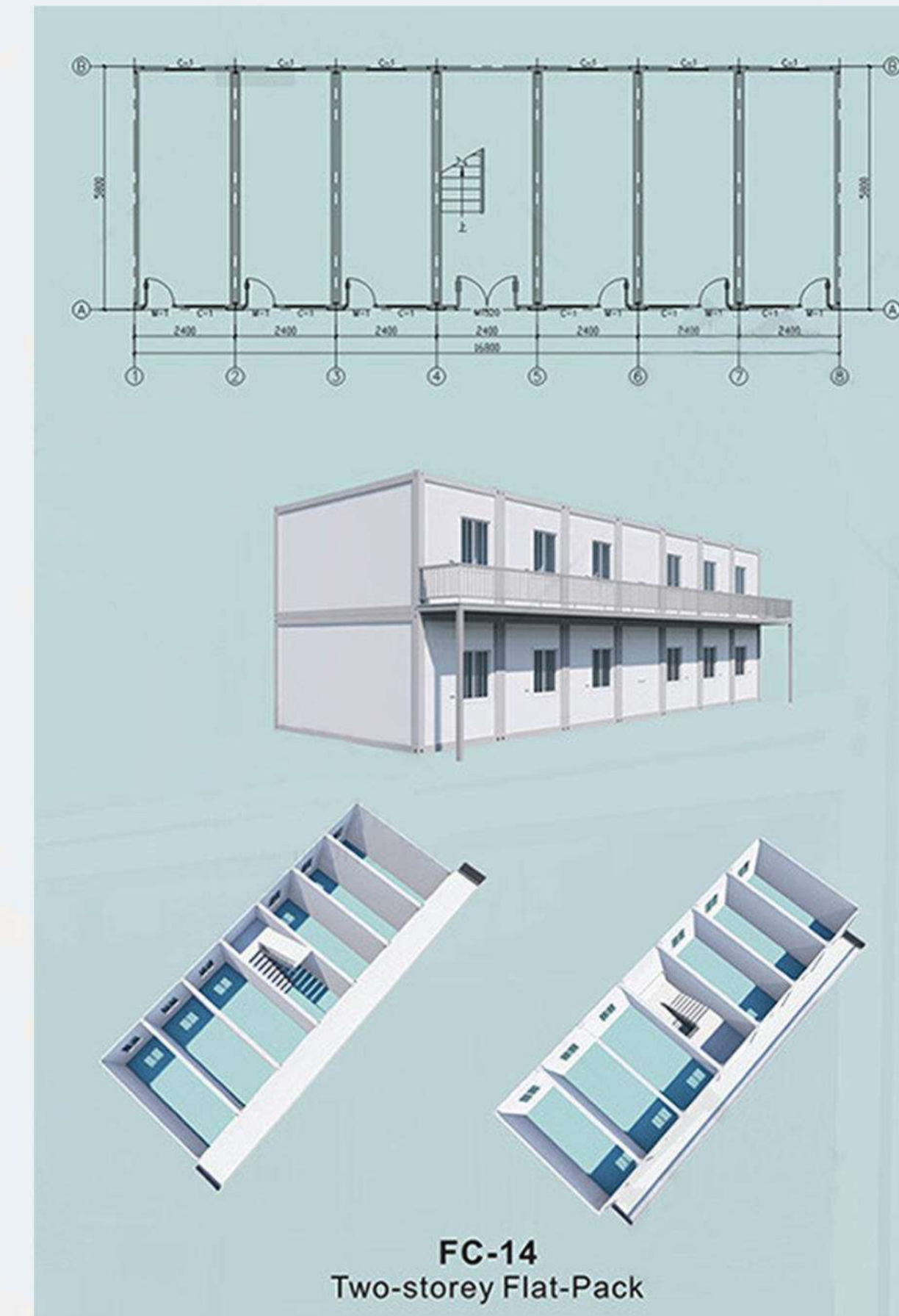
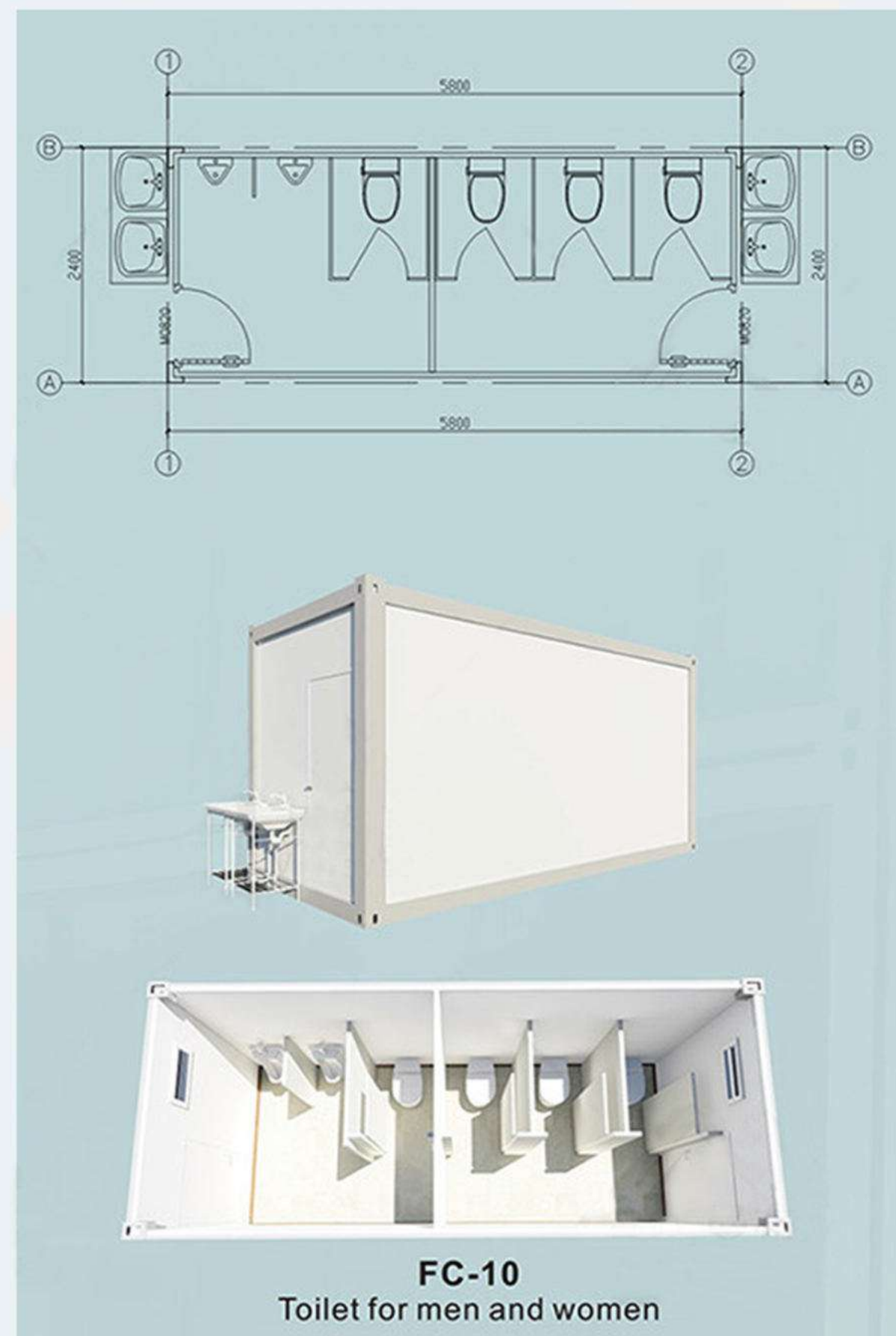
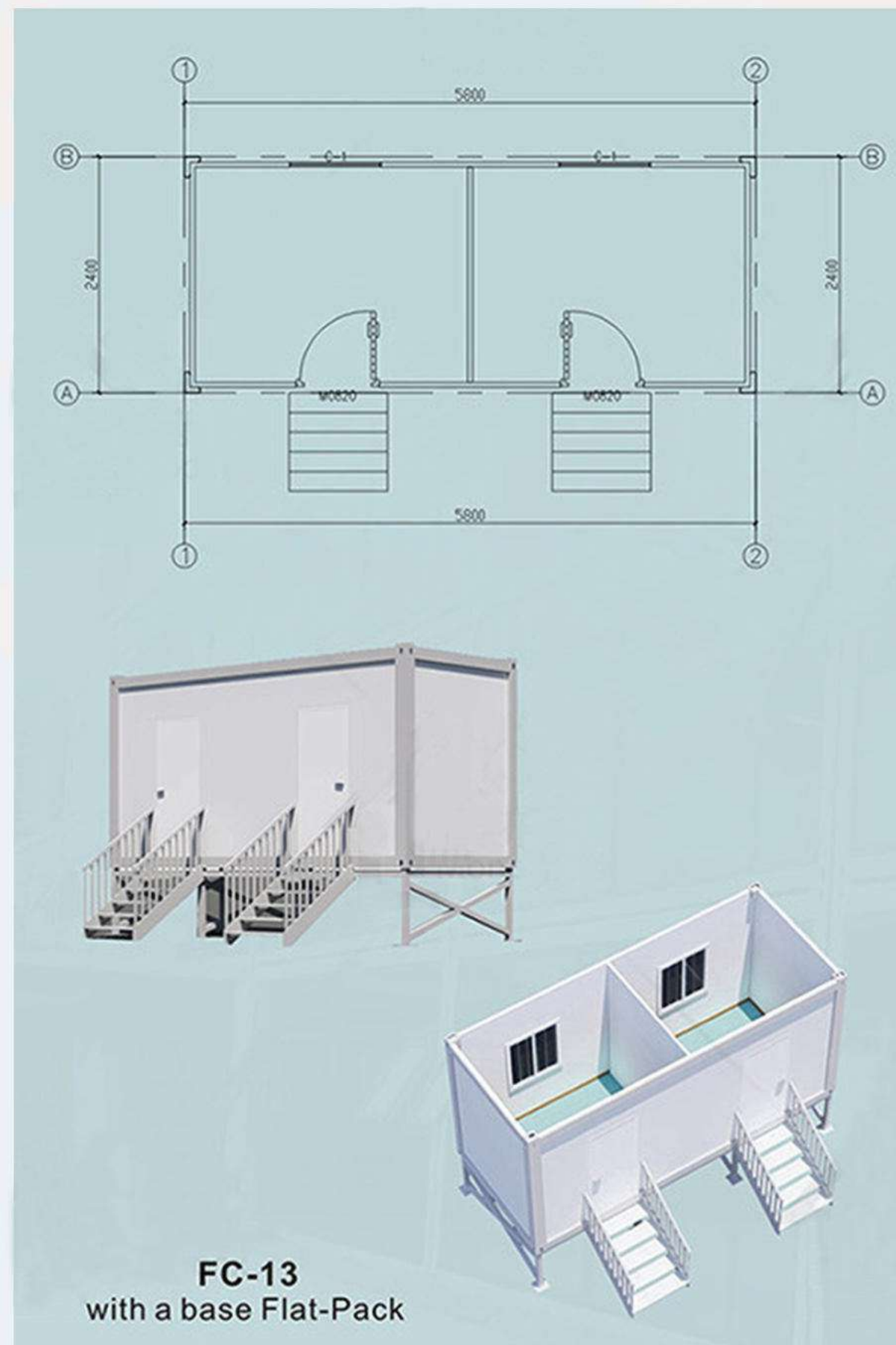
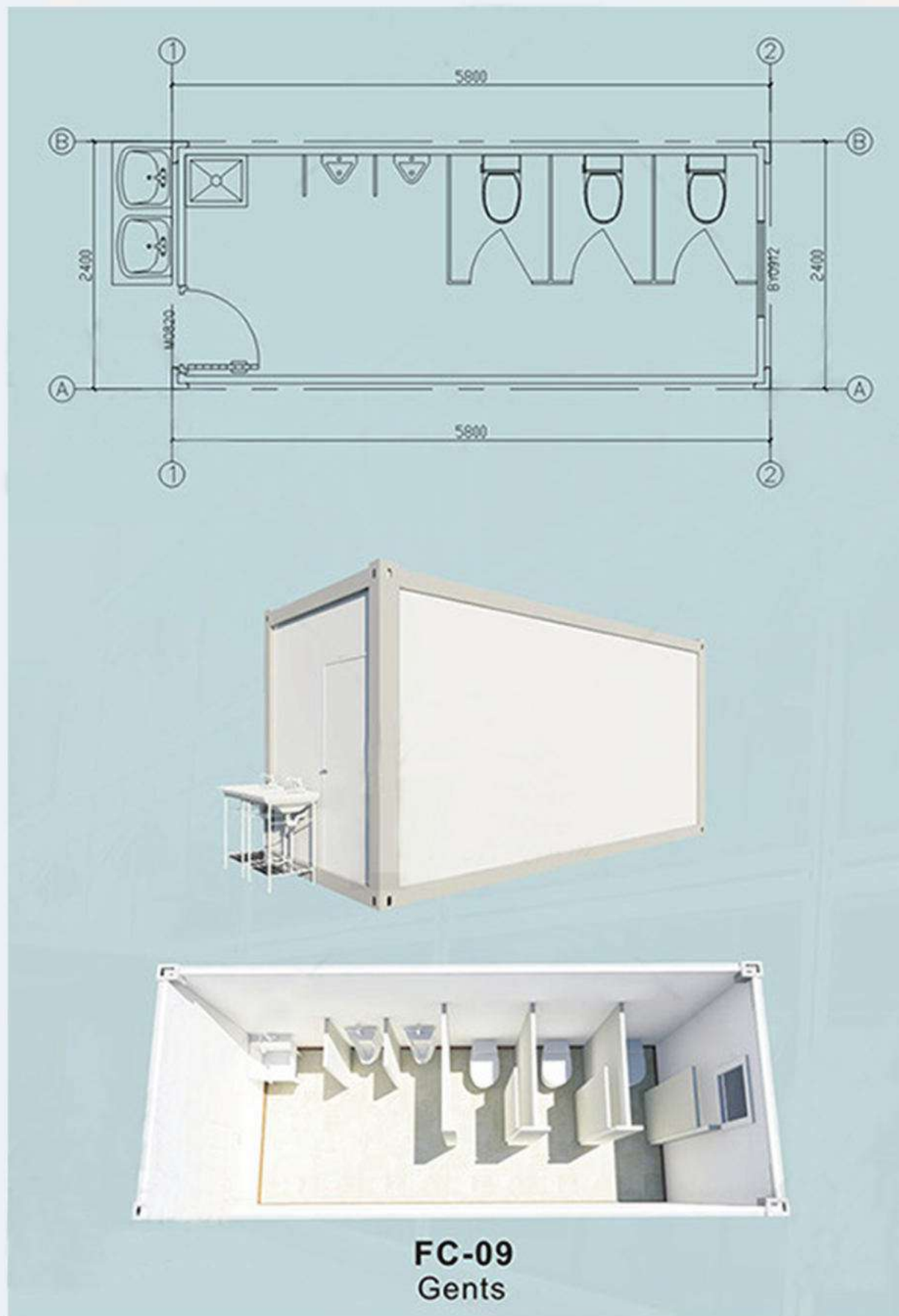

# DETACHABLE CONTAINER HOUSE

Portable Detachable Container is a new generation of prefab house. It is a whole unit itself, which can be used as a single portable house, or combined laterally or stacked it to two or three floors. Detachable Container house can be connected by bolts, with easy installation and fast transportation. Life span is about 15-20 years.



**Multi-styling, More Affordable and Much Convenient**

|                      |                               |
|----------------------|-------------------------------|
| Size                 | 5950mm(L)x3000mm(W)x2800mm(H) |
| Weight               | 1100kg                        |
| Steel structure      | Square tube/Flat tube         |
| Partition wall       | Sandwich panel                |
| Wall                 | Sandwich panel                |
| Roof                 | Sandwich panel                |
| Windows              | 925x1200mm                    |
| Door                 | 925x1980mm Steel door         |
| Wind resistant       | 0.3kN/m <sup>2</sup>          |
| Earthquake resistant | 8 grade                       |
| Time to install      | 2 sets/4 workers/day          |
| Loading              | 14 sets/40HQ                  |
| Floor load capacity  | 3kN/m <sup>2</sup>            |

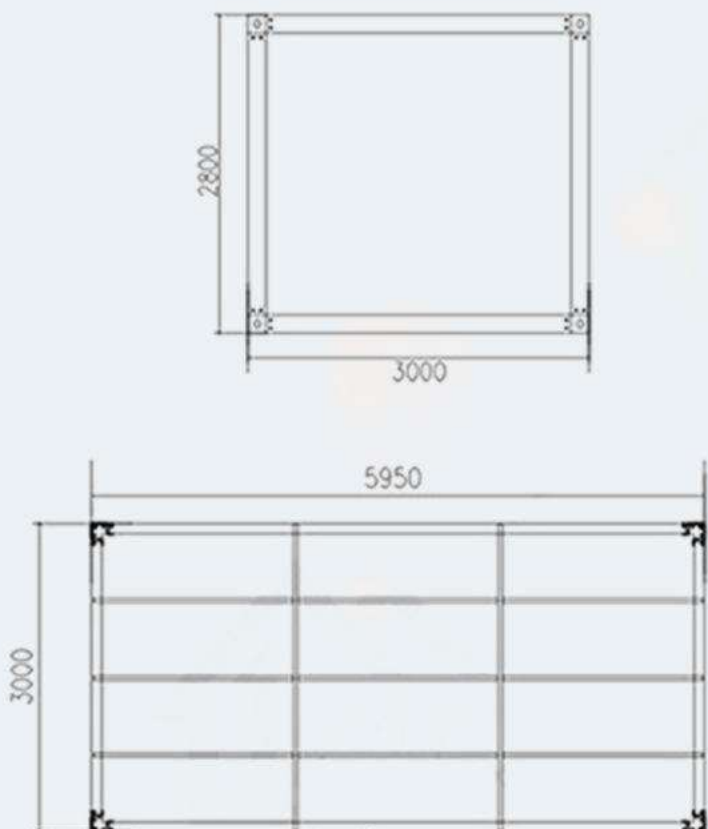
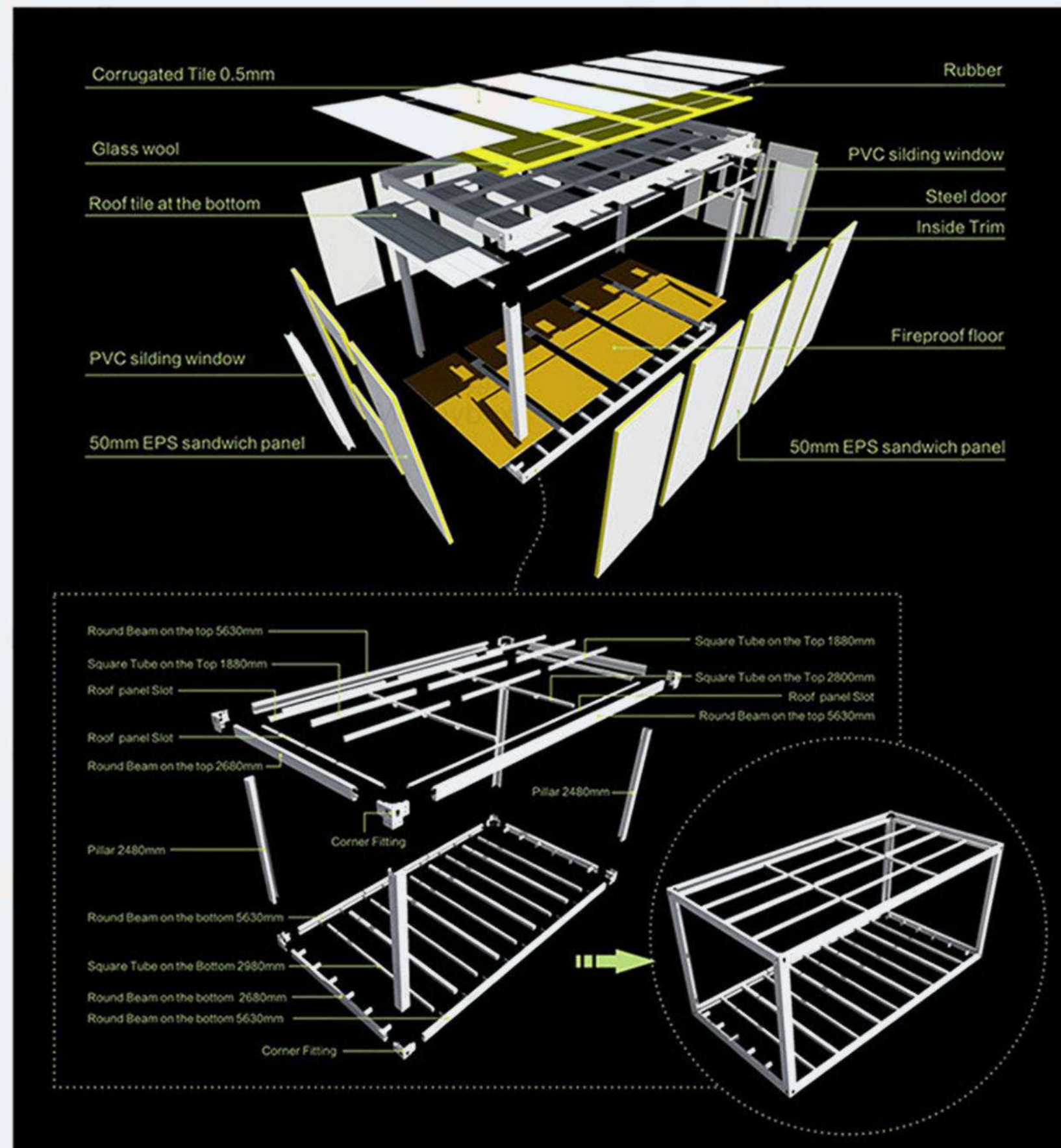

**PRODUCT DETAILS**



➤ **PACKING AND SHIPPING**



➤ **EASY TO INSTALL**





**PRODUCT DETAILS**





# East West

*China Sourcing Solutions*

*Doing business with the world since 1968*



L209

L208

เฉพาะลูกค้าที่เข้าพักเท่านั้น  
Private zone

# Coffee Shop

Modern coffee shop container has excellent lighting effect and beautiful environment. The inspiration of the new building, come from young people's leisure and entertainment gathering place. Coffee House Container can be well integrated with other modern buildings. Compared with conventional construction, it can be produced within a short time with high level of design and low cost.



# Clinic

Containers have also been put to good use in the medical field. It's a low-cost emergency facility that can be easily deployed by helicopter to wherever there is a medical emergency



## TYPICAL LAYOUTS



## PACKING AND SHIPPING



# FOLDING CONTAINER



## EASY TO INSTALL



**SIZE:**  
3000x6000x2750mm

### STRUCTURE

- 1 Column: 100x100x2.0mm square tube
- 2 Bottom frame: 100x100x2.0mm square tube
- 3 Main beam of bottom frame: 40x80x2.0mm tube
- 4 Floor: 18mm high density inorganic fiber board
- 5 50mm A grade fire proof glass wool
- 6 Roof cover: corrugated color steel sheet
- 7 Roof insulation: 50mm glass wool
- 8 Ceiling: corrugated color steel sheet
- 9 Top frame: 100x100x2.0 square tube
- 10 Bottom secondary beam: 40x40x3.5mm angle steel
- 11 Wall: 70mm corrugated sandwich panel

# DIY SHIPPING CONTAINER

## PACKING AND SHIPPING



(Durable Ideal Yare)

## INTRODUCTION

DIY container house is a new container model created by Moneybox, life span can be 15-20 years. It looks similar as standard shipping container, compared with shipping container, it's more economical and has bigger internal area. Even simple modifications can make it to be amazing dormitory, shop, restaurant, office, bathroom etc. All materials will be prefabricated in the factory, easy welding steps can finish to make your beautiful DIY container house.





**Other Devices:**

Waste Tank: 110L



**SPECIFICATION**

1. Wall: 50mm sandwich panel
2. Structure: Alumin
3. Applications: construction site, public toilet on street/park, outdoor party, big activities.....



# HDPE PORTABLE TOILET

**PT100**



Style: Sitting Toilet  
 Size: 1200x1130x2350(mm)  
 Weight: 138kg  
 Water Tank: 130L  
 Waste Tank: 320L  
 Loading: 20gp/40hq: 20pcs/42pcs(skd)  
 40hq: 20pcs(asssembled)  
 Standard Facilities:  
 Flushing Toilet, Hand Wash Basin, Mirror, Tissue Holder, Hook, Metal Base For Forklift  
 Optional Facilities: Defecation Outlet  
 Roof Panel Color: White  
 Door Panel Color: Red/Blue  
 Wall Panel Color: Grey/Blue  
 Sitting Toilet: Marble Style  
 Wash Basin: Marble Style

**PT200**



Style: Squat Toilet  
 Size: 1160x1120x2300(mm)  
 Weight: 120kg  
 Water Tank: 80L  
 Waste Tank: 280L  
 Loading: 20gp/40hq: 20pcs/45pcs(skd)  
 40hq: 20pcs(asssembled)  
 Standard Facilities:  
 Flushing Toilet, Hand Wash Basin, Mirror, Tissue Holder, Hook, Metal Base For Forklift  
 Optional Facilities: Defecation Outlet  
 Roof Panel Color: White  
 Door Panel Color: Red/Blue  
 Wall Panel Color: Grey/Blue  
 Sitting Toilet: Marble Style  
 Wash Basin: Marble Style

**PT350**



Style: Squat Toilet  
 Size: 1100x1350x2450(mm)  
 Weight: 135kg  
 Water Tank: 100L  
 Waste Tank: 320L  
 Loading: 20gp/40hq: 20pcs/45pcs/(skd)  
 40hq: 18pcs(asssembled)  
 Standard Facilities:  
 Flushing Toilet, Hand Wash Basin, Mirror, Tissue Holder, Hook, Metal Base For Forklift  
 Optional Facilities: Defecation Outlet  
 Roof Panel Color: White  
 Door Panel Color: Red/Blue  
 Wall Panel Color: Grey/Blue  
 Sitting Toilet: Marble Style  
 Wash Basin: Marble Style

**PT400**



Style: Squat And Sitting Toilet  
 Standard Facilities:  
 Squat Toilet or Sitting Toilet, Basin.  
 Optional Facilities: Urinal, Shower Head  
 Size: 1150x1150x2300(mm)  
 Weight: g.w. 105kg n.w. 104kg  
 Water Tank: 160L Waste Tank: 390L  
 Standard Color: White, Yellow, Green, Blue  
 Other Color: Customer's Customization



| Item   | Toilet  | Size(mm)       | Equipment   |   | G.W(kg) | N.W(kg) | Loading |      |
|--------|---------|----------------|---|---|---------|---------|---------|------|
|        |         |                |   |   |         |         | 20GP    | 40HQ |
| PT-001 | Sitting | 1100*1100*2300 | Standard: Sitting toilet+wash basin+exhaust fan+light +switch+socket. | Optional: shower+bidets+mirror +hook+waste tank | 98      | 95      | 25      | 60   |
| PT-002 | Squat   | 1100*1100*2300 |   |   | 85      | 83      | 28      | 65   |

## DETAILS OF LUXURY PORTABLE TOILET



### BE APPLICABLE TO :

Outdoor Training&Sporting  
Lawn Weeding  
Park,Construction Site  
Help Disaster Victims  
Mine Site,Outdoor Concert,Labor Camp



## MOVABLE WALL SERIES

Movable Wall is used of steel column,double-sided sandwich plate or single laminated steel plate by bolts connected.Easy installation,good effecton,customized color,fast assemble and disassemble,no construction waste and elegant appearance .

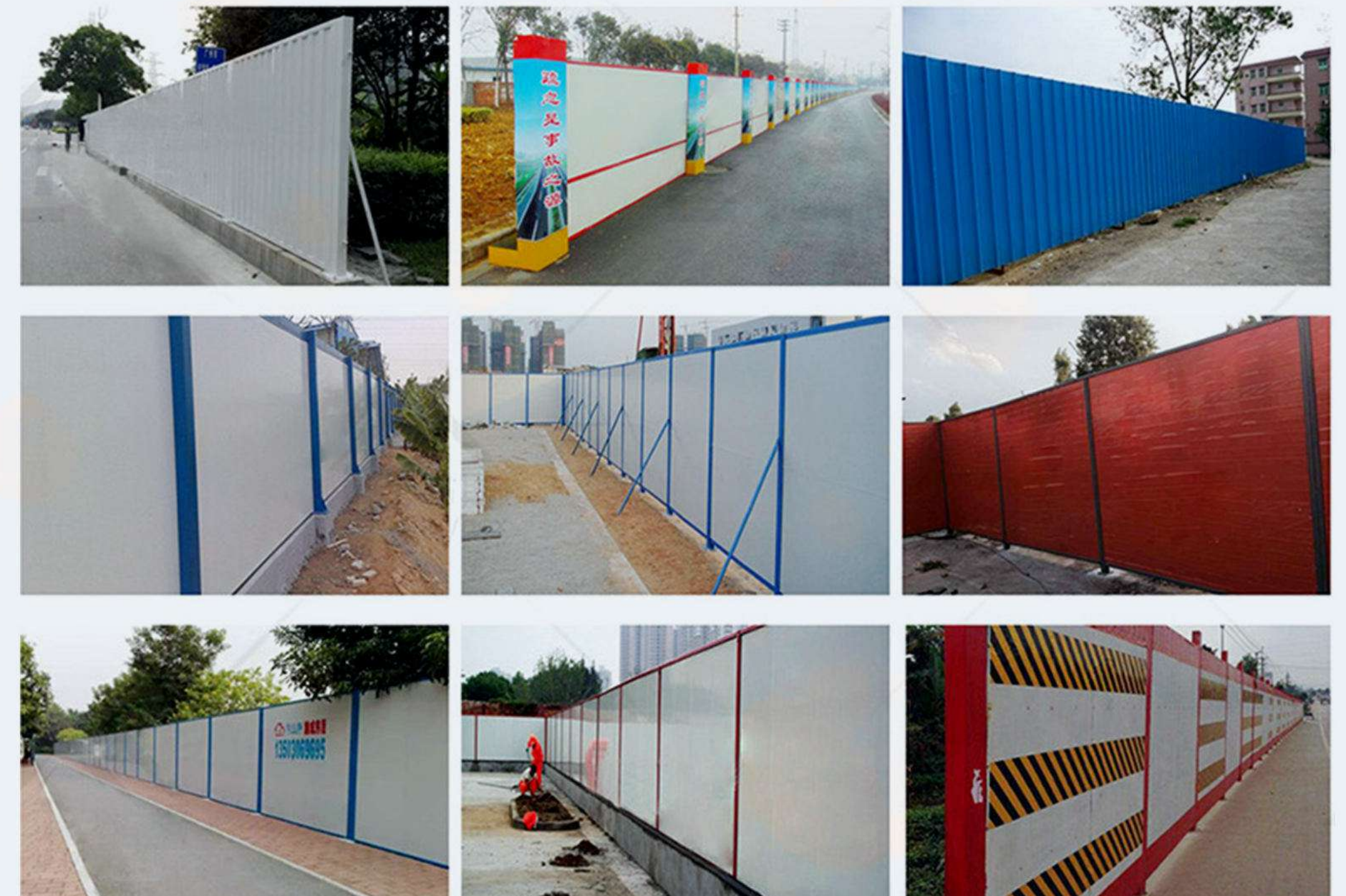

## POST SERIES







*Doing business with the world since 1968*

## EAST WEST CORPORATION LIMITED

Address: Grandmark Room 404, No.10 Granville road, TSIM SHA TSUI  
Kowloon, Hong Kong

TEL. + (852) 2424 8088    Skype " filandarth "

Email : [cbgeorge@biznetvigator.com](mailto:cbgeorge@biznetvigator.com)    Website: [WWW.EWCLCHINA.COM](http://WWW.EWCLCHINA.COM)



COFFEECONTAINER  
3D ILLUSTRATION

**Thank You for watching this short presentation to let us introduce ourselves to you .  
Please contact us for more information according to your budget and market needs**